

GENERAL NOTES

- 1. THE CONTRACTOR AND OWNER'S REPRESENTATIVE SHALL CONTACT THE LANDSCAPE ARCHITECT FOR A PRE-CONSTRUCTION MEETING PRIOR TO START OF ANY WORK SHOWN ON THESE PLANS.
- 2. THESE PLANS SHALL NOT BE UTILIZED FOR CONSTRUCTION OR PERMITTING UNLESS STATED FOR SUCH USE IN THE TITLE BLOCK.
- 3. DRAWINGS ARE INTENDED TO BE PRINTED ON 24 X 36" PAPER. PRINTING THESE DRAWINGS AT A DIFFERENT SIZE WILL IMPACT THE SCALE. VERIFY THE GRAPHIC SCALE BEFORE REFERENCING ANY MEASUREMENTS ON THESE SHEETS. THE RECIPIENT OF THESE DRAWINGS SHALL BE RESPONSIBLE FOR ANY ERRORS RESULTING FROM INCORRECT PRINTING, COPYING, OR ANY OTHER CHANGES THAT ALTER THE SCALE OF THE DRAWINGS.
- 4. VERIFY ALL PLAN DIMENSIONS PRIOR TO START OF CONSTRUCTION. NOTIFY THE OWNER'S REPRESENTATIVE TO ADDRESS ANY QUESTIONS OR CLARIFY ANY DISCREPANCIES.
- 5. WRITTEN DIMENSIONS TAKE PRECEDENCE OVER SCALED DIMENSIONS.
- 6. REVISIONS TO THESE DOCUMENTS, REVIEW AND CONSIDERATIONS OF SUBSTITUTIONS, OWNER DIRECTED CHANGES, AND/OR RFI RESPONSES WHICH REQUIRE PROVIDING ADDITIONAL DETAIL AFTER APPROVAL OF THE PERMIT SET MAY REQUIRE APPROVAL OF AN ADDITIONAL SERVICES REQUEST BY THE CLIENT.
- 7. SUBMIT A CHANGE ORDER FOR APPROVAL FOR ANY CHANGES TO WORK SCOPE RESULTING FROM FIELD CONDITIONS OR DIRECTION BY OWNER'S REPRESENTATIVE WHICH REQUIRE ADDITIONAL COST TO THE OWNER PRIOR TO PERFORMANCE OF WORK.
- 8. THE CONTRACTOR SHALL PROVIDE A STAKED LAYOUT OF ALL SITE IMPROVEMENTS FOR INSPECTION BY THE OWNER'S REPRESENTATIVE AND MAKE MODIFICATIONS AS REQUIRED. ALL LAYOUT INFORMATION IS AVAILABLE IN DIGITAL FORMAT FOR USE BY THE CONTRACTOR.
- 9. IF A GEOTECHNICAL SOILS REPORT IS NOT AVAILABLE AT THE TIME OF CONSTRUCTION, NORRIS DESIGN RECOMMENDS A REPORT BE AUTHORIZED BY THE OWNER AND THAT ALL RECOMMENDATIONS OF THE REPORT ARE FOLLOWED DURING CONSTRUCTION. THE CONTRACTOR SHALL USE THESE CONTRACT DOCUMENTS AS A BASIS FOR THE BID. IF THE OWNER ELECTS TO PROVIDE A GEOTECHNICAL REPORT, THE CONTRACTOR SHALL REVIEW THE REPORT AND SUBMIT AN APPROPRIATE CHANGE ORDER TO THE OWNER'S REPRESENTATIVE IF ADDITIONAL COSTS ARE REQUESTED.
- 10. CONTRACTOR SHALL CONFIRM THAT SITE CONDITIONS ARE SIMILAR TO THE PLANS, WITHIN TOLERANCES STATED IN THE CONTRACT DOCUMENTS, AND SATISFACTORY TO THE CONTRACTOR PRIOR TO START OF WORK. SHOULD SITE CONDITIONS BE DIFFERENT THAN REPRESENTED ON THE PLANS OR UNSATISFACTORY TO THE CONTRACTOR, THE CONTRACTOR SHALL CONTACT THE OWNER'S REPRESENTATIVE FOR CLARIFICATION AND FURTHER DIRECTION.
- 11. CONTRACTOR IS RESPONSIBLE TO PAY FOR, AND OBTAIN, ANY REQUIRED APPLICATIONS, PERMITTING, LICENSES, INSPECTIONS AND METERS ASSOCIATED WITH WORK.
- 12. THE CONTRACTOR SHALL BE RESPONSIBLE FOR ANY FINES OR PENALTIES ASSESSED TO THE OWNER RELATING TO ANY VIOLATIONS OR NON-CONFORMANCE WITH THE PLANS, SPECIFICATIONS, CONTRACT DOCUMENTS, JURISDICTIONAL CODES, AND REGULATORY AGENCIES.
- 13. THE CONTRACTOR SHALL BE RESPONSIBLE FOR COORDINATION OF ALL UTILITY LOCATES PRIOR TO ANY EXCAVATION. REFER TO ENGINEERING UTILITY PLANS FOR ALL PROPOSED UTILITY LOCATIONS AND DETAILS. NOTIFY OWNER'S REPRESENTATIVE IF EXISTING OR PROPOSED UTILITIES INTERFERE WITH THE ABILITY TO PERFORM WORK.
- 14. UNLESS IDENTIFIED ON THE PLANS FOR DEMOLITION OR REMOVAL, THE CONTRACTOR IS RESPONSIBLE FOR THE COST TO REPAIR UTILITIES, ADJACENT OR EXISTING LANDSCAPE, ADJACENT OR EXISTING PAVING, OR ANY PUBLIC AND PRIVATE PROPERTY THAT IS DAMAGED BY THE CONTRACTOR OR THEIR SUBCONTRACTOR'S OPERATIONS DURING INSTALLATION, ESTABLISHMENT OR DURING THE SPECIFIED MAINTENANCE PERIOD. ALL DAMAGES SHALL BE REPAIRED TO PRE-CONSTRUCTION CONDITIONS AS DETERMINED BY THE OWNER'S REPRESENTATIVE. CONTRACTOR SHALL BE RESPONSIBLE FOR LOGGING ANY DAMAGES PRIOR TO START OF CONSTRUCTION AND DURING THE CONTRACT PERIOD.
- 15. ALL WORK SHALL BE CONFINED TO THE AREA WITHIN THE CONSTRUCTION LIMITS AS SHOWN ON THE PLANS. ANY AREAS OR IMPROVEMENTS DISTURBED OUTSIDE THESE LIMITS SHALL BE RETURNED TO THEIR ORIGINAL CONDITION AT THE CONTRACTOR'S EXPENSE. IN THE EVENT THE CONTRACTOR REQUIRES A MODIFICATION TO THE CONSTRUCTION LIMITS, WRITTEN PERMISSION MUST BE OBTAINED FROM THE OWNER'S REPRESENTATIVE PRIOR TO ANY DISTURBANCE OUTSIDE OF THE LIMITS OF WORK.
- 16. THE CONTRACTOR SHALL BE RESPONSIBLE FOR THE REPAIR OF ANY OF THEIR TRENCHES OR EXCAVATIONS THAT SETTLE.
- 17. THE CONTRACTOR SHALL BE RESPONSIBLE TO PREPARE AND SUBMIT A TRAFFIC CONTROL PLAN TO THE APPROPRIATE JURISDICTIONAL AGENCIES AND THE OWNER'S REPRESENTATIVE IF THEIR WORK AND OPERATIONS AFFECT OR IMPACT THE PUBLIC RIGHTS-OF-WAY. OBTAIN APPROVAL PRIOR TO ANY WORK WHICH AFFECTS OR IMPACTS THE PUBLIC RIGHTS-OF-WAY. THE CONTRACTOR SHALL BE RESPONSIBLE FOR ANY FINES OR PENALTIES ASSESSED TO THE OWNER RELATING TO THIS REQUIREMENT DURING THE CONTRACT PERIOD.
- 18. SIGHT TRIANGLES AND SIGHT LINES SHALL REMAIN UNOBSTRUCTED BY EQUIPMENT, CONSTRUCTION MATERIALS, PLANT MATERIAL OR ANY OTHER VISUAL OBSTACLE DURING THE CONTRACT PERIOD AND AT MATURITY OF PLANTS PER LOCAL JURISDICTIONAL REQUIREMENTS.
- 19. NO PLANT MATERIAL OTHER THAN GROUND COVER IS ALLOWED TO BE PLANTED ADJACENT TO FIRE HYDRANTS AS STIPULATED BY JURISDICTIONAL REQUIREMENTS.
- 20. COORDINATE SITE ACCESS, STAGING, STORAGE AND CLEANOUT AREAS WITH OWNER'S REPRESENTATIVE.
- 21. CONTRACTOR IS RESPONSIBLE FOR PROVIDING TEMPORARY SAFETY FENCING AND BARRIERS AROUND ALL IMPROVEMENTS SUCH AS WALLS, PLAY STRUCTURES, EXCAVATIONS, ETC. ASSOCIATED WITH THEIR WORK UNTIL SUCH FACILITIES ARE COMPLETELY INSTALLED PER THE PLANS, SPECIFICATIONS AND MANUFACTURER'S RECOMMENDATIONS.
- 22. CONTRACTOR SHALL BE RESPONSIBLE FOR PROTECTION OF THEIR MATERIAL STOCK PILES AND WORK FROM VANDALISM, EROSION OR UNINTENDED DISTURBANCE DURING THE CONSTRUCTION PERIOD AND UNTIL FINAL ACCEPTANCE IS ISSUED.
- 23. THE CONTRACTOR SHALL KNOW, UNDERSTAND AND ABIDE BY ANY STORM WATER POLLUTION PREVENTION PLAN (SWPPP) ASSOCIATED WITH THE SITE. IF A STORM WATER POLLUTION PREVENTION PLAN IS NOT PROVIDED BY THE OWNER'S REPRESENTATIVE, REQUEST A COPY BEFORE PERFORMANCE OF ANY SITE WORK.
- 24. MAINTAIN ANY STORM WATER MANAGEMENT FACILITIES THAT EXIST ON SITE FOR FULL FUNCTIONALITY. THE CONTRACTOR SHALL INSTALL AND MAINTAIN ANY NEW STORM WATER MANAGEMENT FACILITIES THAT ARE IDENTIFIED IN THE SCOPE OF WORK TO FULL FUNCTIONALITY. THE CONTRACTOR SHALL BE RESPONSIBLE FOR ANY FINES OR PENALTIES ASSESSED TO THE OWNER FOR FAILURE TO MAINTAIN STORM WATER MANAGEMENT FACILITIES DURING THE CONTRACT PERIOD.

- 25. THE CONTRACTOR SHALL PREVENT SEDIMENT, DEBRIS AND ALL OTHER POLLUTANTS FROM EXITING THE SITE OR ENTERING THE STORM SEWER SYSTEM DURING ALL DEMOLITION OR CONSTRUCTION OPERATIONS THAT ARE PART OF THIS PROJECT. THE CONTRACTOR SHALL BE RESPONSIBLE FOR ANY FINES OR PENALTIES ASSESSED TO THE OWNER RELATING TO THESE REQUIREMENTS DURING THEIR CONTRACTED COURSE OF WORK.
- 26. THE CONTRACTOR SHALL BE RESPONSIBLE TO PREVENT ANY IMPACTS TO ADJACENT WATERWAYS, WETLANDS, OR OTHER ENVIRONMENTALLY SENSITIVE AREAS RESULTING FROM WORK DONE AS PART OF THIS PROJECT. THE CONTRACTOR SHALL BE RESPONSIBLE FOR ANY FINES OR PENALTIES ASSESSED TO THE OWNER RELATING TO THESE STANDARDS DURING THEIR CONTRACTED COURSE OF WORK.
- 27. THE CONTRACTOR AND/OR THEIR AUTHORIZED AGENTS SHALL ENSURE THAT ALL LOADS OF CONSTRUCTION MATERIAL IMPORTED TO OR EXPORTED FROM THE PROJECT SITE SHALL BE PROPERLY COVERED TO PREVENT LOSS OF MATERIAL DURING TRANSPORT. TRANSPORTATION METHODS ON PUBLIC RIGHT-OF WAYS SHALL CONFORM TO JURISDICTIONAL REQUIREMENTS. THE CONTRACTOR SHALL BE RESPONSIBLE FOR ANY FINES OR PENALTIES ASSESSED TO THE OWNER RELATING TO THESE REQUIREMENTS.
- 28. THE CLEANING OF EQUIPMENT IS PROHIBITED AT THE JOB SITE UNLESS AUTHORIZED BY THE OWNER'S REPRESENTATIVE IN A DESIGNATED AREA. THE DISCHARGE OF WATER, WASTE CONCRETE, POLLUTANTS, OR OTHER MATERIALS SHALL ONLY OCCUR IN AREAS DESIGNATED FOR SUCH USE AND APPROVED BY THE OWNER'S REPRESENTATIVE.
- 29. THE CLEANING OF CONCRETE EQUIPMENT IS PROHIBITED AT THE JOB SITE EXCEPT IN DESIGNATED CONCRETE WASHOUT AREAS. THE DISCHARGE OF WATER CONTAINING WASTE CONCRETE IN THE STORM SEWER IS PROHIBITED.
- 30. THE USE OF REBAR, STEEL STAKES, OR STEEL FENCE POSTS TO STAKE DOWN STRAW OR HAY BALES OR TO SUPPORT SILT FENCING USED AS AN EROSION CONTROL MEASURE IS PROHIBITED.
- 31. OPEN SPACE SWALES: IF SWALES ARE EXISTING ON SITE AND ARE NOT INTENDED TO BE MODIFIED AS PART OF THE PLANS, THE CONTRACTOR SHALL BE RESPONSIBLE TO MAINTAIN THE CONVEYANCE OF WATER WITHIN THE SWALES DURING THE CONTRACT PERIOD. THE CONTRACTOR SHALL BE RESPONSIBLE FOR ANY DIVERSION OR PUMPING OF WATER IF REQUIRED TO COMPLETE WORK. ANY SWALES DISTURBED BY THE CONTRACTOR SHALL BE REPAIRED/RESTORED TO THEIR ORIGINAL CONDITION. IF THE SWALE NEEDS TO BE DISTURBED OR MODIFIED FOR ANY REASON, THE CONTRACTOR SHALL NOTIFY THE OWNER'S REPRESENTATIVE FOR APPROVAL PRIOR TO DISTURBANCE.
- 32. DETENTION AND WATER QUALITY PONDS: IF DETENTION PONDS AND WATER QUALITY PONDS ARE EXISTING ON SITE AND ARE NOT INTENDED TO BE MODIFIED AS PART OF THE PLANS, THE CONTRACTOR SHALL MINIMIZE DISTURBANCE TO THE PONDS, DRAINAGE STRUCTURES AND SPILLWAYS DURING CONSTRUCTION. ALL PONDS, DRAINAGE STRUCTURES AND SPILLWAYS SHALL BE MAINTAINED IN OPERABLE CONDITIONS AT ALL TIMES. ANY POND OR SPILLWAY AREAS DISTURBED BY THE CONTRACTOR SHALL BE REPAIRED/RESTORED TO THEIR ORIGINAL CONDITION. IF THE POND NEEDS TO BE DISTURBED OR MODIFIED FOR ANY REASON, THE CONTRACTOR SHALL NOTIFY THE OWNER'S REPRESENTATIVE FOR APPROVAL PRIOR TO DISTURBANCE.
- 33. MAINTENANCE ACCESS BENCHES: IF MAINTENANCE BENCHES OR ACCESS ROADS EXIST ON SITE AND ARE NOT INTENDED TO BE MODIFIED AS PART OF THE PLANS, THE CONTRACTOR SHALL MINIMIZE DISTURBANCE TO THE BENCHES OR ACCESS ROADS DURING CONSTRUCTION. ANY BENCHES OR ACCESS ROADS DISTURBED BY THE CONTRACTOR SHALL BE REPAIRED/RESTORED TO THEIR ORIGINAL CONDITION. THE CONTRACTOR SHALL MAINTAIN ACCESS TO ALL EXISTING BENCHES AND ACCESS ROADS DURING THE CONSTRUCTION PERIOD. IF ACCESS NEEDS TO BE BLOCKED FOR ANY REASON, THE CONTRACTOR SHALL NOTIFY THE OWNER'S REPRESENTATIVE FOR APPROVAL PRIOR TO INTERRUPTION OF ACCESS.
- 34. LOCAL, STATE AND FEDERAL JURISDICTIONAL REQUIREMENTS, RESTRICTIONS OR PROCEDURES SHALL SUPERSEDE THESE PLANS, NOTES AND SPECIFICATIONS WHEN MORE STRINGENT. NOTIFY THE OWNER'S REPRESENTATIVE IF CONFLICTS OCCUR.

LAYOUT NOTES

- 1. WRITTEN DIMENSIONS WILL TAKE PRECEDENCE OVER SCALED DIMENSIONS.
- 2. SHOULD SITE CONDITIONS BE DIFFERENT THAN WHAT IS INDICATED ON THE DRAWINGS CONTACT THE LANDSCAPE ARCHITECT IMMEDIATELY FOR CLARIFICATION.
- 3. CURVED WALKS AND CURB EDGES ARE INTENDED TO BE CONSTRUCTED WITH SMOOTH FLOWING CURVES. ANYTHING OTHER THAN SMOOTH FLOWING CURVES WILL BE REJECTED.
- 4. THE CONTRACTOR SHALL OBTAIN, AT THEIR EXPENSE, ALL PERMITS WHICH ARE NECESSARY TO PERFORM THE PROPOSED WORK.
- 5. THE CONTRACTOR SHALL COORDINATE WITH THE OWNER REGARDING WHO WILL PROVIDE SURVEY SERVICES FOR LAYOUT OF THE WORK.
- 6. THE CONTRACTOR SHALL REVIEW WITH OWNER'S REPRESENTATIVE AND LANDSCAPE ARCHITECT ALL STAKING PRIOR TO SETTING FORMS OR COMPLETING FLATWORK AND PERFORM MINOR MODIFICATIONS AS REQUIRED TO ACHIEVE PROPER DRAINAGE OR ACCESSIBILITY AS REQUIRED FOR THE DESIGN, AT NO ADDITIONAL COST TO THE OWNER.
- 7. THE CONTRACTOR SHALL INSTALL SLEEVING FOR IRRIGATION IMPROVEMENTS PRIOR TO INSTALLING CONCRETE FLATWORK. REFER TO IRRIGATION PLANS.
- 8. LAYOUT WALKS, SCORE JOINTS AND PAVING PATTERNS AS CLOSELY AS POSSIBLE TO PLANS, DETAILS, AND SPECIFICATIONS. DO NOT DEVIATE FROM PLANS UNLESS SPECIFIC APPROVAL IS OBTAINED FROM THE OWNER'S REPRESENTATIVE.
- 9. ALL WORK SHALL BE CONFINED TO THE AREA WITHIN THE CONSTRUCTION LIMITS AS SHOWN ON THE PLANS. ANY AREAS OR IMPROVEMENTS DISTURBED OUTSIDE THESE LIMITS SHALL BE RETURNED TO THEIR ORIGINAL CONDITION AT THE CONTRACTOR'S EXPENSE. IN THE EVENT THE CONTRACTOR REQUIRES A MODIFICATION TO THE CONSTRUCTION LIMITS, WRITTEN PERMISSION MUST BE OBTAINED FROM THE LANDSCAPE ARCHITECT PRIOR TO ANY DISTURBANCE OUTSIDE OF THE LIMITS OF WORK. SEE TECHNICAL SPECIFICATIONS.
- 10. WHEN APPLICABLE CONTRACTOR IS RESPONSIBLE FOR PROVIDING TEMPORARY FENCING AROUND ALL PLAY STRUCTURES UNTIL PROPER FALL SURFACE IS COMPLETELY INSTALLED PER MANUFACTURER'S SPECIFICATIONS.
- 11. CONTRACTOR IS RESPONSIBLE FOR SUPERVISING ALL SAFETY SURFACING AND PAVEMENT DURING THE CURING PROCESS.

GENERAL LANDSCAPE NOTES

- 1. THE CONTRACTOR SHALL FOLLOW THE LANDSCAPE PLANS AND SPECIFICATIONS AS CLOSELY AS POSSIBLE. ANY SUBSTITUTION OR ALTERATION SHALL NOT BE ALLOWED WITHOUT APPROVAL OF THE OWNER'S REPRESENTATIVE. OVERALL PLANT QUANTITY AND QUALITY SHALL BE CONSISTENT WITH THE PLANS.
- 2. THE CONTRACTOR IS RESPONSIBLE FOR VERIFYING ALL PLANT QUANTITIES. GRAPHIC QUANTITIES TAKES PRECEDENCE OVER WRITTEN QUANTITIES.
- 3. THE OWNER'S REPRESENTATIVE RESERVES THE RIGHT TO INSPECT AND TAG ALL PLANT MATERIAL PRIOR TO SHIPPING TO THE SITE. IN ALL CASES, THE OWNER'S REPRESENTATIVE MAY REJECT PLANT MATERIAL AT THE SITE IF MATERIAL IS DAMAGED, DISEASED, OR DECLINING IN HEALTH AT THE TIME OF ONSITE INSPECTIONS OR IF THE PLANT MATERIAL DOES NOT MEET THE MINIMUM SPECIFIED STANDARD IDENTIFIED ON THE PLANS AND IN THE SPECIFICATIONS. THE CONTRACTOR SHALL COORDINATE WITH THE OWNER'S REPRESENTATIVE FOR INSPECTION AND APPROVAL OF ALL MATERIALS AND PRODUCTS PRIOR TO INSTALLATION.
- 4. THE OWNER'S REPRESENTATIVE MAY ELECT TO UPSIZE PLANT MATERIAL AT THEIR DISCRETION BASED ON SELECTION, AVAILABILITY, OR TO ENHANCE SPECIFIC AREAS OF THE PROJECT. THE CONTRACTOR SHALL VERIFY PLANT MATERIAL SIZES WITH OWNER'S REPRESENTATIVE PRIOR TO PURCHASING, SHIPPING OR STOCKING OF PLANT MATERIALS. SUBMIT CHANGE ORDER REQUEST TO OWNER'S REPRESENTATIVE FOR APPROVAL IF ADDITIONAL COST IS REQUESTED BY THE CONTRACTOR PRIOR TO INSTALLATION. RE-STOCKING CHARGES WILL NOT BE APPROVED IF THE CONTRACTOR FAILS TO SUBMIT A REQUEST FOR MATERIAL CHANGES.
- 5. THE CONTRACTOR SHALL WARRANT ALL CONTRACTED WORK AND MATERIALS FOR A PERIOD OF ONE YEAR AFTER SUBSTANTIAL COMPLETION HAS BEEN ISSUED BY THE OWNER'S REPRESENTATIVE FOR THE ENTIRE PROJECT UNLESS OTHERWISE SPECIFIED IN THE CONTRACT DOCUMENTS OR SPECIFICATIONS.
- 6. REFER TO IRRIGATION PLANS FOR LIMITS AND TYPES OF IRRIGATION DESIGNED FOR THE LANDSCAPE. IN NO CASE SHALL IRRIGATION BE EMITTED WITHIN THE MINIMUM DISTANCE FROM BUILDING OR WALL FOUNDATIONS AS STIPULATED IN THE GEOTECHNICAL REPORT. ALL IRRIGATION DISTRIBUTION LINES, HEADS AND EMITTERS SHALL BE KEPT OUTSIDE THE MINIMUM DISTANCE AWAY FROM ALL BUILDING AND WALL FOUNDATIONS AS STIPULATED IN THE GEOTECHNICAL REPORT.
- 7. LANDSCAPE MATERIAL LOCATIONS SHALL HAVE PRECEDENCE OVER IRRIGATION MAINLINE AND LATERAL LOCATIONS. COORDINATE INSTALLATION OF IRRIGATION EQUIPMENT SO THAT IT DOES NOT INTERFERE WITH THE PLANTING OF TREES OR OTHER LANDSCAPE MATERIAL.
- 8. THE LANDSCAPE CONTRACTOR SHALL BE RESPONSIBLE FOR ENSURING POSITIVE DRAINAGE EXISTS IN ALL LANDSCAPE AREAS. SURFACE DRAINAGE ON LANDSCAPE AREAS SHALL NOT FLOW TOWARD STRUCTURES AND FOUNDATIONS. MAINTAIN SLOPE AWAY FROM FOUNDATIONS PER THE GEOTECHNICAL REPORT RECOMMENDATIONS. ALL LANDSCAPE AREAS BETWEEN WALKS AND CURBS SHALL DRAIN FREELY TO THE CURB UNLESS OTHERWISE IDENTIFIED ON THE GRADING PLAN. IN NO CASE SHALL THE GRADE, TURF THATCH, OR OTHER LANDSCAPE MATERIALS DAM WATER AGAINST WALKS. MINIMUM SLOPES ON LANDSCAPE AREAS SHALL BE 2%; MAXIMUM SLOPE SHALL BE 25% UNLESS SPECIFICALLY IDENTIFIED ON THE PLANS OR APPROVED BY THE OWNER'S REPRESENTATIVE.
- 9. PRIOR TO INSTALLATION OF PLANT MATERIALS, AREAS THAT HAVE BEEN COMPACTED OR DISTURBED BY CONSTRUCTION ACTIVITY SHALL BE THOROUGHLY LOOSENED TO A DEPTH OF 8" - 12" AND AMENDED PER SPECIFICATIONS.
- 10. ALL LANDSCAPED AREAS ARE TO RECEIVE ORGANIC SOIL PREPARATION AT 4 cu.yds/1,000sf OR AS NOTED IN THE TECHNICAL SPECIFICATIONS.
- 11. TREES SHALL NOT BE LOCATED IN DRAINAGE SWALES, DRAINAGE AREAS, OR UTILITY EASEMENTS. CONTACT OWNER'S REPRESENTATIVE FOR RELOCATION OF PLANTS IN QUESTIONABLE AREAS PRIOR TO INSTALLATION.
- 12. THE CENTER OF EVERGREEN TREES SHALL NOT BE PLACED CLOSER THAN 8' AND THE CENTER OF ORNAMENTAL TREES CLOSER THAN 6' FROM A SIDEWALK, STREET OR DRIVE LANE. EVERGREEN TREES SHALL NOT BE LOCATED ANY CLOSER THAN 15' FROM IRRIGATION ROTOR HEADS. NOTIFY OWNER'S REPRESENTATIVE IF TREE LOCATIONS CONFLICT WITH THESE STANDARDS FOR FURTHER DIRECTION.
- 13. ALL EVERGREEN TREES SHALL BE FULLY BRANCHED TO THE GROUND AND SHALL NOT EXHIBIT SIGNS OF ACCELERATED GROWTH AS DETERMINED BY THE OWNER'S REPRESENTATIVE.
- 14. ALL TREES ARE TO BE STAKED AND GUYED PER DETAILS FOR A PERIOD OF 1 YEARS. THE CONTRACTOR SHALL BE RESPONSIBLE FOR REMOVING STAKES AT THE END OF 1 YEARS FROM ACCEPTANCE OF LANDSCAPE INSTALLATION BY THE OWNER'S REPRESENTATIVE. OBTAIN APPROVAL BY OWNER'S REPRESENTATIVE PRIOR TO REMOVAL.
- 15. ALL TREES IN SEED OR TURF AREAS SHALL RECEIVE MULCH RINGS. OBTAIN APPROVAL FROM OWNER'S REPRESENTATIVE FOR ANY TREES THAT WILL NOT BE MULCHED FOR EXCESSIVE MOISTURE REASONS.
- 16. AT SEED AREA BOUNDARIES ADJACENT TO EXISTING NATIVE AREAS, OVERLAP ABUTTING NATIVE AREAS BY THE FULL WIDTH OF THE SEEDER.
- 17. EXISTING TURF AREAS THAT ARE DISTURBED DURING CONSTRUCTION, ESTABLISHMENT AND THE MAINTENANCE PERIOD SHALL BE RESTORED WITH NEW SOD TO MATCH EXISTING TURF SPECIES. DISTURBED NATIVE AREAS WHICH ARE TO REMAIN SHALL BE OVER SEEDED AND RESTORED WITH SPECIFIED SEED MIX.
- 18. ALL SEEDED SLOPES EXCEEDING 25% IN GRADE (4:1) SHALL RECEIVE EROSION CONTROL BLANKETS. PRIOR TO INSTALLATION, NOTIFY OWNER'S REPRESENTATIVE FOR APPROVAL OF LOCATION AND ANY ADDITIONAL COST IF A CHANGE ORDER IS NECESSARY.

GRADING NOTES

- 1. THE CONTRACTOR IS TO REVIEW, UNDERSTAND AND ADHERE TO SPOT ELEVATIONS AND CONTOURS AS INDICATED ON THE GRADING PLAN UNLESS SPECIFICALLY AUTHORIZED BY THE OWNER'S REPRESENTATIVE. CONTRACTOR SHALL VERIFY THAT ALL MINIMUM AND MAXIMUM SLOPES IDENTIFIED ON THE PLANS ARE ACHIEVABLE IN THE FIELD PRIOR TO START OF WORK.
- 2. THE CONTRACTOR SHALL BE RESPONSIBLE FOR COORDINATION OF ALL STAKING NECESSARY TO COMPLETE THE WORK. THIS SHALL INCLUDE ANY RE-STAKING IF NECESSARY. THE CONTRACTOR SHALL PAY FOR ALL STAKING FOR THE PROJECT UNLESS SPECIFICALLY AGREED TO OTHERWISE IN THE CONTRACT DOCUMENTS.
- 3. ALL AREAS SHALL BE GRADED TO ACHIEVE POSITIVE DRAINAGE. MINIMUM SLOPE ON LANDSCAPED AREAS SHALL BE 2%; MAXIMUM SLOPE SHALL BE 25% (4:1) UNLESS OTHERWISE INDICATED ON THE PLANS.
- 4. MAXIMUM ALLOWED FINAL GRADES FOR LONGITUDINAL SLOPE ON WALKS AND PAVED AREAS SHALL BE 5% UNLESS OTHERWISE INDICATED ON THE PLANS.
- 5. ALL FINAL GRADES FOR WALKS SHALL HAVE A MINIMUM 1% CROSS SLOPE AND MAXIMUM 2% CROSS SLOPE UNLESS OTHERWISE INDICATED ON THE PLANS.
- 6. EXCAVATION INCLUDES ALL MATERIAL ENCOUNTERED TO WHATEVER DEPTH INDICATED ON THE PLANS. EXCAVATE TO ALLOW FOR PROPER FILL MATERIAL, SLABS, VOIDS, FORMS, AND FOUNDATIONS.
- 7. REFER TO SPECIFICATIONS FOR ADDITIONAL INFORMATION REGARDING GRADING AND EXCAVATION INCLUDING GUIDELINES AND RESTRICTIONS FOR EARTHWORK AND PLACING OF PAVEMENT AND LANDSCAPE SURFACING FOR THIS PROJECT.
- 8. CONTRACTOR SHALL ENSURE EXISTING GRADES ARE WITHIN 0.1 OF A FOOT PRIOR TO START OF WORK, AND SHALL NOTIFY OWNER'S REPRESENTATIVE IF CONDITIONS ARE DIFFERENT, PRIOR TO THE START OF WORK.
- 9. CONTRACTOR SHALL ENSURE THEIR COMPLETED GRADES ARE WITHIN 0.01 OF A FOOT WHEN COMPLETED WITH WORK.
- 10. FINISH GRADE SHOWN ON THESE PLANS SHALL REPRESENT COMPACTION REQUIREMENTS AS DEFINED BY PLANS, DETAILS, AND SPECIFICATIONS.

WATER CONSERVATION CHECKLIST

- 1. ALL TREES, SHRUBS, AND PERENNIALS SHALL BE DRIP IRRIGATED.
- 2. ONLY NATIVE SEED/GRASS AREAS TO BE SPRAY IRRIGATED.
- 3. IRRIGATION TIMERS TO BE PROVIDED FOR IRRIGATION SYSTEM.
- 4. PRECIPITATION SENSORS TO BE PROVIDED FOR IRRIGATION SYSTEM.
- 5. ONLY WATER CONSERVING NATIVE SEED MIXES TO BE USED FOR GRASS AREAS.

SHEET INDEX

LANDSCAPE NOTES	L-1.00
LANDSCAPE AND MATERIAL SCHEDULES	L-2.00
LANDSCAPE PLAN	L-3.00
LANDSCAPE PLAN	L-3.01
LANDSCAPE PLAN	L-3.02
LANDSCAPE PLAN	L-3.03
LANDSCAPE DETAILS	L-4.00

KEY MAP

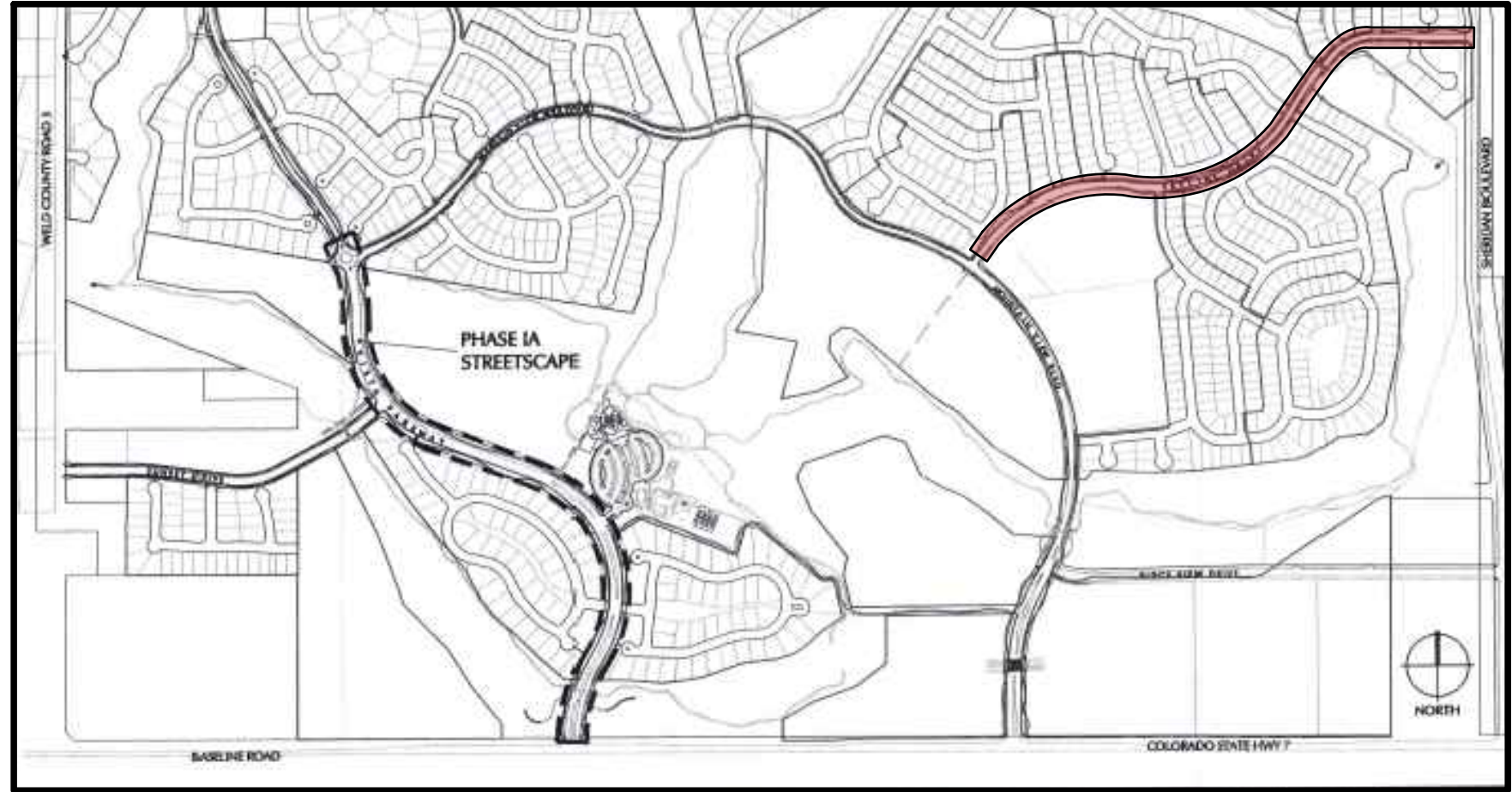

CHECKED BY: SS AZ, BP, CR
DRAWN BY:

NORRIS DESIGN
 PEOPLE + PLACEMAKING
 1101 BANNOCK STREET
 DENVER, CO 80204
 P 303.892.1166

NORRIS-DESIGN.COM

SKYLINE DRIVE
VISTA RIDGE STREETScape

OWNER:
VISTA RIDGE METROPOLITAN DISTRICT

DATE:
 6/27/2023
 10/13/2023
 11/20/2023
 12/21/2023

SHEET TITLE:
COVER

PLANT SCHEDULE

	<u>QTY</u>	<u>BOTANICAL NAME</u>	<u>COMMON NAME</u>	<u>ROOT</u>	<u>SIZE</u>
<u>DECIDUOUS SHRUBS</u>					
AM LE	27	AMORPHA CANESCENS	LEADPLANT	CONT.	#5
AR LS	141	ARONIA MELANOCARPA 'UCONNAM165'	LOW SCAPE MOUND® BLACK CHOKEBERRY	CONT.	#5
AR TR	12	ARTEMISIA TRIDENTATA	BIG SAGEBRUSH	CONT.	#5
BU AL	3	BUDDLEJA ALTERNIFOLIA 'ARGENTEA'	SILVER FOUNTAIN BUTTERFLY BUSH	CONT.	#5
CA DA	90	CARYOPTERIS X CLANDONENSIS 'DARK KNIGHT'	DARK KNIGHT BLUEBEARD	CONT.	#5
CA MR	175	CARYOPTERIS X CLANDONENSIS CARYOPTERIS X CLANDONENSIS	BLUE MIST SPIREA	CONT.	#5
CH NN	144	CHRYSOETHAMNUS NAUSEOSUS NAUCEOSUS	BABY BLUE RABBITBRUSH	CONT.	#5
CO RE	10	CORNUS SERICEA	RED TWIG DOGWOOD	CONT.	#5
CY SP	27	CYTISUS PURGANS 'SPANISH GOLD'	SPANISH GOLD BROOM	CONT.	#5
CY LE	108	CYTISUS X 'LENA'	LENA BROOM	CONT.	#5
DA CM	15	DAPHNE X BURKWOODII 'CAROL MACKIE'	CAROL MACKIE DAPHNE	CONT.	#5
FA PA	2	FALLUGIA PARADOXA	APACHE PLUME	CONT.	#5
HO DU	13	HOLIDISCUS DUMOSUS	ROCK SPIREA	CONT.	#5
JA AM	2	JAMESIA AMERICANA	WAXFLOWER	CONT.	#5
PE LS	60	PEROVSKIA ATRIPLICIFOLIA 'LITTLE SPIRE' TM	LITTLE SPIRE RUSSIAN SAGE	CONT.	#5
PH CH	6	PHILADELPHUS LEWISII 'CHEYENNE'	LEWIS MOCK ORANGE	CONT.	#5
PH LI	72	PHYSOCARPUS OPULIFOLIUS 'LITTLE DEVIL'	LITTLE DEVIL™ DWARF NINEBARK	CONT.	#5
PO FR	68	POTENTILLA FRUTICOSA	BUSH CINQUEFOIL	CONT.	#5
PO MW	24	POTENTILLA FRUTICOSA 'MCKAY'S WHITE'	MCKAY'S WHITE BUSH CINQUEFOIL	CONT.	#5
PO PB	45	POTENTILLA FRUTICOSA 'PINK BEAUTY'	PINK BEAUTY POTENTILLA	CONT.	#5
PR PB	116	PRUNUS BESSEYI PAWNEE BUTTES	CREEPING WESTERN SAND CHERRY	CONT.	#5
RH GR	24	RHUS AROMATICA 'GRO-LOW'	GRO-LOW FRAGRANT SUMAC	CONT.	#5
<u>EVERGREEN SHRUBS</u>					
AR CO	11	ARCTOSTAPHYLOS X COLORADOENSIS	MOCK BEARBERRY MANZANITA	CONT.	#5
AR PA	147	ARCTOSTAPHYLOS X COLORADOENSIS 'PANCHITO'	PANCHITO MANZANITA	CONT.	#5
CH MI	15	CHAMAEBATIARIA MILLEFOLIUM	FERNBUSH	CONT.	#5
HE PA	91	HESPERALOE PARVIFLORA	RED YUCCA	CONT.	#5
<u>ORNAMENTAL GRASSES</u>					
BO BA	92	BOUTELOUA GRACILIS 'BLONDE AMBITION'	BLOND AMBITION BLUE GRAMA GRASS	CONT.	#1
NA TE	44	NASSELLA TENUISSIMA	MEXICAN FEATHER GRASS	CONT.	#1
PE KR	14	PENNISETUM ORIENTALE 'KARLEY ROSE'	KARLEY ROSE FOUNTAIN GRASS	CONT.	#1
<u>PERENNIALS</u>					
AC MO	31	ACHILLEA X 'MOONSHINE'	MOONSHINE YARROW	CONT.	#1
PE ST	6	PENSTEMON STRICTUS	ROCKY MOUNTAIN PENSTEMON	CONT.	#1
RA PU	39	RATIBIDA COLUMNIFERA PULCHERRIMA	PRAIRIE RED CONEFLOWER	CONT.	#1

MATERIAL SCHEDULE

<u>ITEM</u>	<u>DESCRIPTION</u>	<u>MANUFACTURER</u>	<u>SIZE/DIMENSIONS</u>	<u>PRODUCT NAME</u>	<u>COLOR / FINISH</u>	<u>NOTES</u>
A	COBBLE TYPE A	PIONEER SAND OR APPROVED EQUAL	1-2"	TBD	TBD	RE: PLAN FOR LOCATION
B	COBBLE TYPE B	PIONEER SAND OR APPROVED EQUAL	2-4"	TBD	TBD	RE: PLAN FOR LOCATION
C	LANDSCAPE BOULDERS	PIONEER SAND OR APPROVED EQUAL	TBD	TBD	TBD	RE: PLAN FOR LOCATION
D	STEEL EDGER	RYERSON OR APPROVED EQUAL	5/16" GAUGE	TBD	BLACK	STEEL ROLLED EDGE WITH ASSOCIATED STAKED SPACED PER SPECIFICATIONS

DOUGLAS COUNTY PERMANENT SEED MIX (WATER CONSERVING)

<u>COMMON NAME</u>	<u>% OF TOTAL</u>	<u>LBS PER ACRE</u>
BIG BLUESTEM	12%	1.1 LBS.
INDIAN GRASS	11%	1.0 LBS.
SWITCH GRASS	5%	0.4 LBS.
SIDE OATS GRAMA	10%	0.9 LBS.
WESTERN WHEAT GRASS	17%	1.6 LBS.
BLUE GRAMA	4%	0.3 LBS.
THICKSPIKE WHEAT GRASS	11%	1.0 LBS.
PRAIRIE SANDREED	7%	0.7 LBS.
GREEN NEEDLE GRASS	11%	1.0 LBS.
SLENDER WHEAT GRASS	6%	0.6 LBS.
STREAM BANK WHEAT GRASS	6%	0.6 LBS.
TOTAL	100%	9.2 LBS.

SKYLINE DRIVE
VISTA RIDGE STREETSCAPE

OWNER:
VISTA RIDGE METROPOLITAN DISTRICT

DATE:
6/27/2023
10/13/2023
11/20/2023
12/21/2023

SHEET TITLE:
PLANT SCHEDULE &
MATERIALS

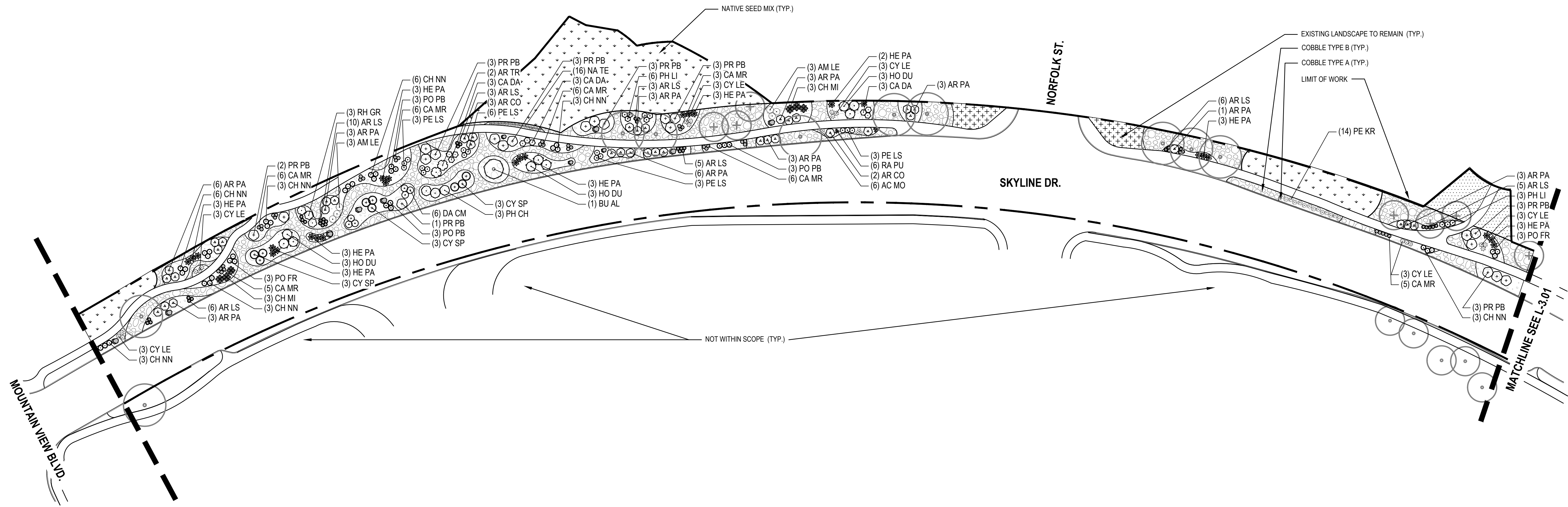

KEY MAP

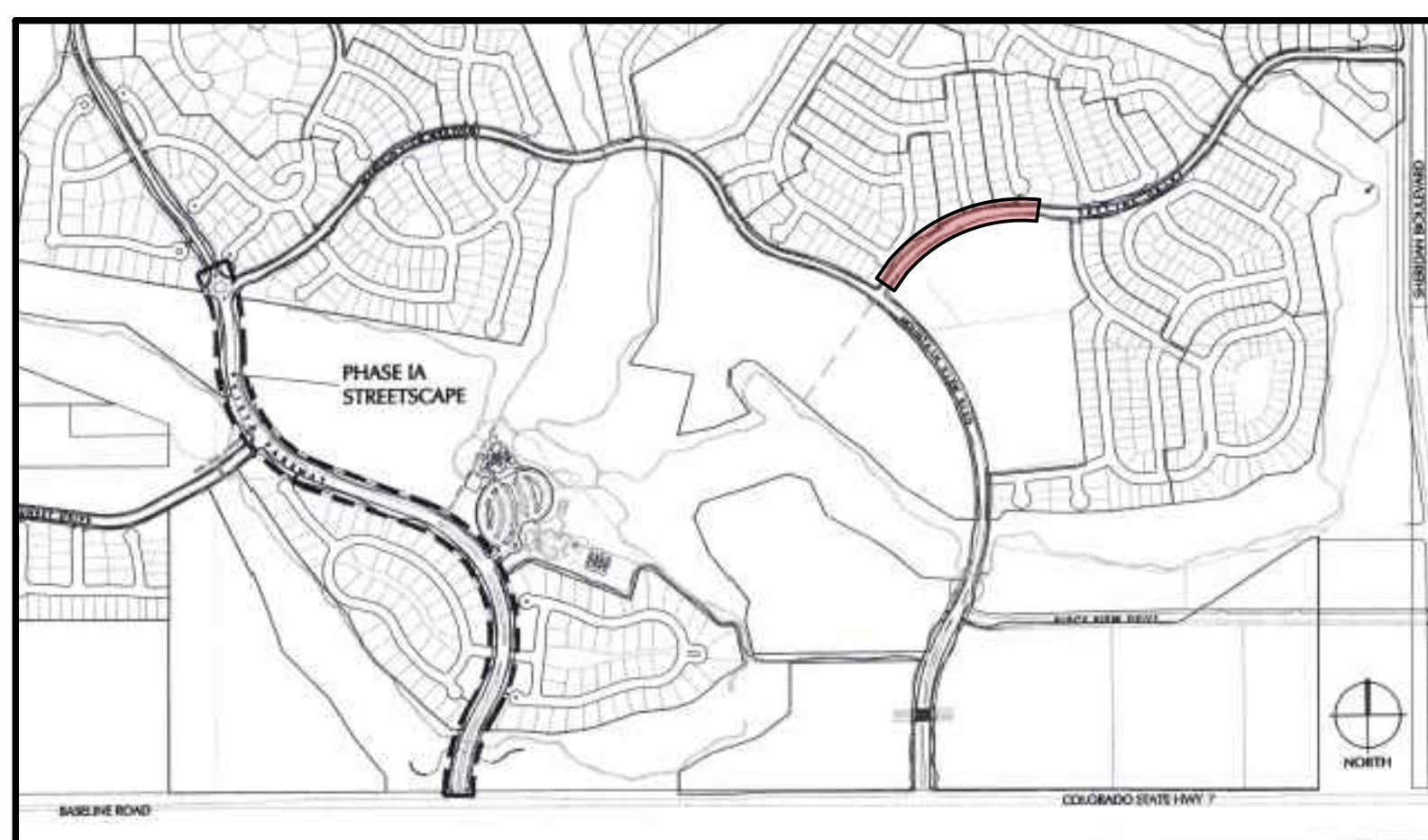

LEGEND

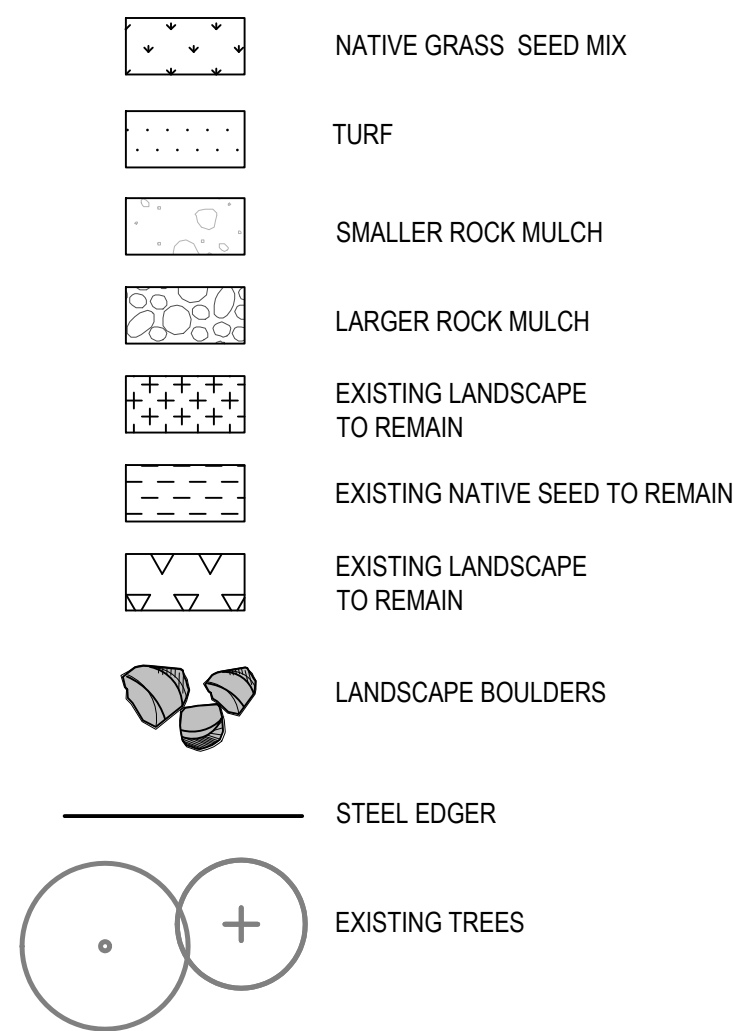

PLANT SCHEDULE

DECIDUOUS SHRUBS	QTY	BOTANICAL NAME	COMMON NAME
AM LE	6	AMORPHA CANESCENS	LEADPLANT
AR LS	38	ARONIA MELANOCARPA 'UCONNAM165'	LOW SCAPE MOUND® BLACK CHOKEBERRY
AR TR	2	ARTEMISIA TRIDENTATA	BIG SAGEBRUSH
BU AL	1	BUDDLEJA ALTERNIFOLIA 'ARGENTEA'	SILVER FOUNTAIN BUTTERFLY BUSH
CA DA	9	CARYOPTERIS X CLANDONENSIS 'DARK KNIGHT'	DARK KNIGHT BLUEBEARD
CA MR	37	CARYOPTERIS X CLANDONENSIS CARYOPTERIS X CLANDONENSIS	BLUE MIST SPIREA
CH NN	27	CHRYSOTHAMNUS NAUSEOSUS NAUCEOSUS	BABY BLUE RABBITBRUSH
CY SP	9	CYTISUS PURGANS 'SPANISH GOLD'	SPANISH GOLD BROOM
CY LE	18	CYTISUS X 'LENA'	LENA BROOM
DA CM	6	DAPHNE X BURKWOODII 'CAROL MACKIE'	CAROL MACKIE DAPHNE
HO DU	9	HOLODISCUS DUMOSUS	ROCK SPIREA
PE LS	15	PEROVSKIA ATRIPLICIFOLIA 'LITTLE SPIRE'™	LITTLE SPIRE RUSSIAN SAGE
PH CH	3	PHILADELPHUS LEWISII 'CHEYENNE'	LEWIS MOCK ORANGE
PH LI	9	PHYSOCARPUS OPULIFOLIUS 'LITTLE DEVIL'	LITTLE DEVIL™ DWARF NINEBARK
PO FR	6	POTENTILLA FRUTICOSA	BUSH CINQUEFOIL
PO PB	9	POTENTILLA FRUTICOSA 'PINK BEAUTY'	PINK BEAUTY POTENTILLA
PR PB	21	PRUNUS BESSEYI PAWNEE BUTTES	CREeping WESTERN SAND CHERRY
RH GR	3	RHUS AROMATICA 'GRO-LOW'	GRO-LOW FRAGRANT SUMAC
EVERGREEN SHRUBS	QTY	BOTANICAL NAME	COMMON NAME
AR CO	5	ARCTOSTAPHYLOS X COLORADOENSIS	MOCK BEARBERRY MANZANITA
AR PA	34	ARCTOSTAPHYLOS X COLORADOENSIS 'PANCHITO'	PANCHITO MANZANITA
CH MI	6	CHAMAEBATIARIA MILLEFOLIUM	FERNBUSH
HE PA	26	HESPERALOE PARVIFLORA	RED YUCCA
ORNAMENTAL GRASSES	QTY	BOTANICAL NAME	COMMON NAME
NA TE	16	NASSELLA TENUISSIMA	MEXICAN FEATHER GRASS
PE KR	14	PENNISETUM ORIENTALE 'KARLEY ROSE'	KARLEY ROSE FOUNTAIN GRASS
PERENNIALS	QTY	BOTANICAL NAME	COMMON NAME
AC MO	6	ACHILLEA X 'MOONSHINE'	MOONSHINE YARROW
RA PU	6	RATIBIDA COLUMNIFERA PULCHERRIMA	PRAIRIE RED CONEFLOWER

DATE:

6/27/2023
10/13/2023
11/20/2023
12/21/2023

SHEET TITLE:

LANDSCAPE PLAN

L-3.00

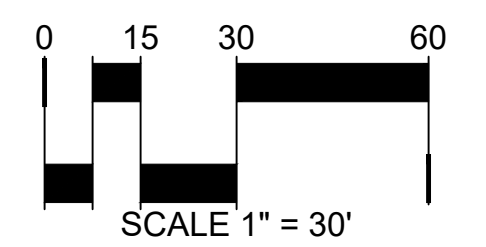

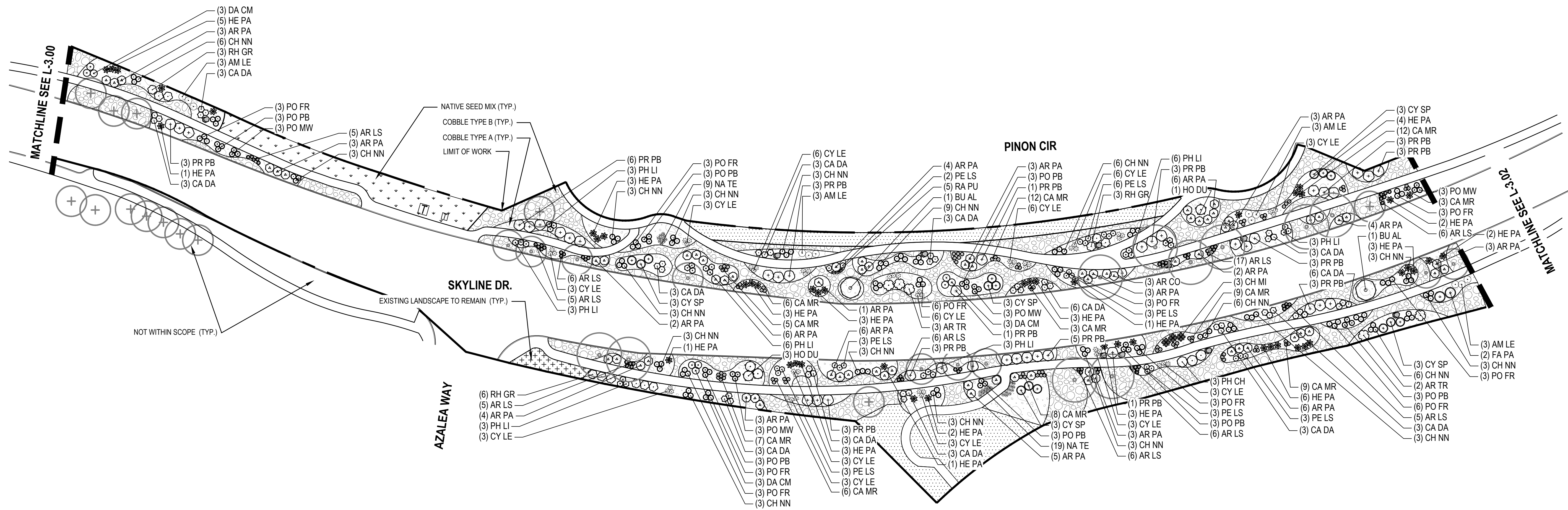

**SKYLINE DRIVE
VISTA RIDGE STREETSCAPE**

OWNER:
VISTA RIDGE METROPOLITAN DISTRICT

KEY MAP

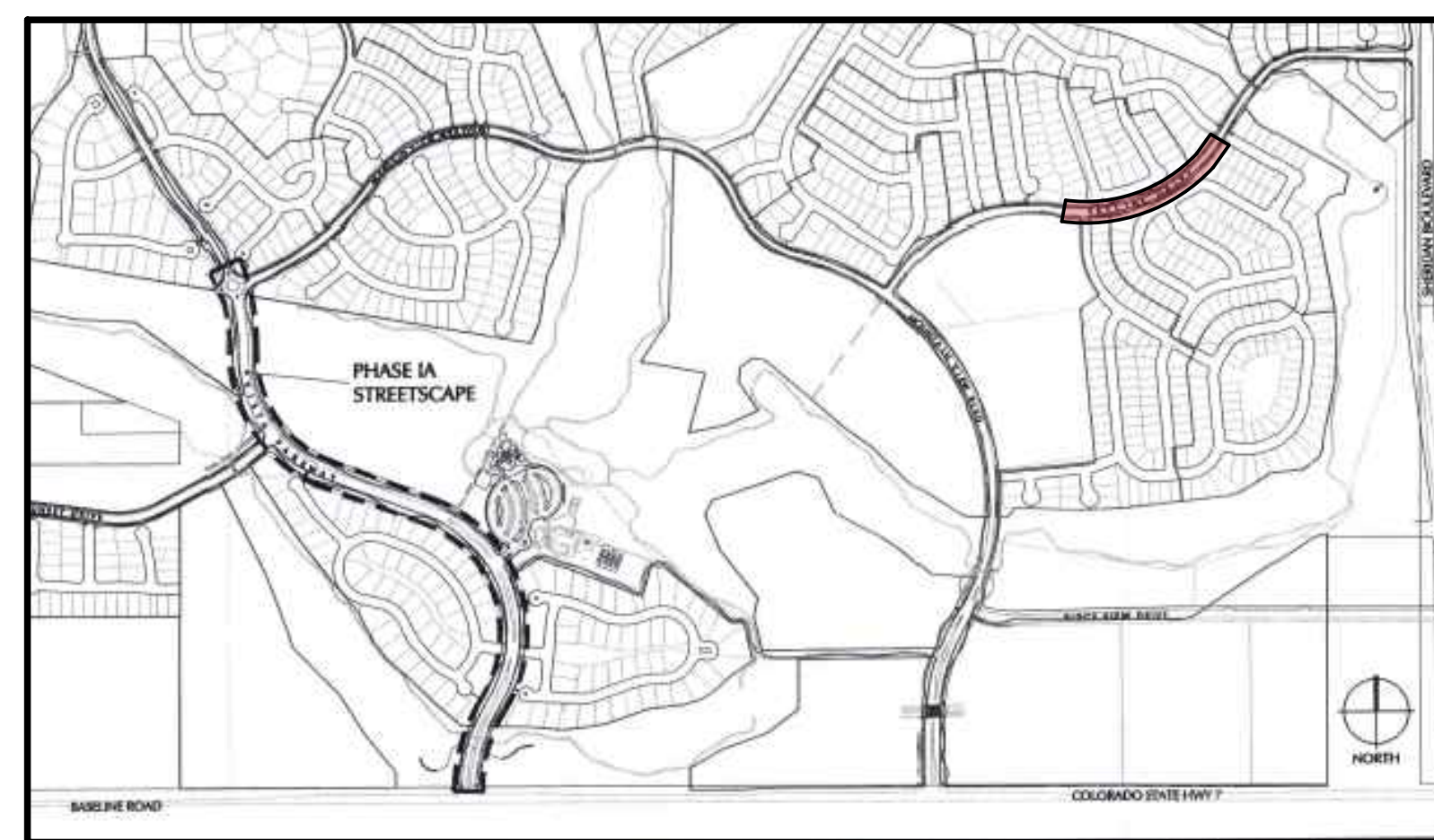

LEGEND

- NATIVE GRASS SEED MIX
- TURF
- SMALLER ROCK MULCH
- LARGER ROCK MULCH
- EXISTING LANDSCAPE TO REMAIN
- EXISTING NATIVE SEED TO REMAIN
- EXISTING LANDSCAPE TO REMAIN
- LANDSCAPE BOULDERS
- STEEL EDGER
- EXISTING TREES

PLANT SCHEDULE

DECIDUOUS SHRUBS		QTY	BOTANICAL NAME	COMMON NAME
AM LE		12	AMORPHA CANESCENS	LEADPLANT
AR LS		67	ARONIA MELANOCARPA 'UCONNAM165'	LOW SCAPE MOUND® BLACK CHOKEBERRY
AR TR		5	ARTEMISIA TRIDENTATA	BIG SAGEBRUSH
BU AL		2	BUDDLEJA ALTERNIFOLIA 'ARGENTEA'	SILVER FOUNTAIN BUTTERFLY BUSH
CA DA		45	CARYOPTERIS X CLANDONENSIS 'DARK KNIGHT'	DARK KNIGHT BLUEBEARD
CA MR		80	CARYOPTERIS X CLANDONENSIS CARYOPTERIS X CLANDONENSIS	BLUE MIST SPIREA
CH NN		72	CHRYSOTHAMNUS NAUSEOSUS NAUCEOSUS	BABY BLUE RABBITBRUSH
CY SP		15	CYTISUS PURGANS 'SPANISH GOLD'	SPANISH GOLD BROOM
CY LE		51	CYTISUS X 'LENA'	LENA BROOM
DA CM		9	DAPHNE X BURKWOODII 'CAROL MACKIE'	CAROL MACKIE DAPHNE
FA PA		2	FALLUGIA PARADOXA	APACHE PLUME
HO DU		4	HOLODISCUS DUMOSUS	ROCK SPIREA
PE LS		23	PEROVSKIA ATRIPLICIFOLIA 'LITTLE SPIRE'™	LITTLE SPIRE RUSSIAN SAGE
PH CH		3	PHILADELPHUS LEWISII 'CHEYENNE'	LEWIS MOCK ORANGE
PH LI		27	PHYSOCARPUS OPULIFOLIUS 'LITTLE DEVIL'	LITTLE DEVIL™ DWARF NINEBARK
PO FR		36	POTENTILLA FRUTICOSA	BUSH CINQUEFOIL
PO MW		12	POTENTILLA FRUTICOSA 'MCKAY'S WHITE'	MCKAY'S WHITE BUSH CINQUEFOIL
PO PB		21	POTENTILLA FRUTICOSA 'PINK BEAUTY'	PINK BEAUTY POTENTILLA
PR PB		41	PRUNUS BESSEYI PAWNEE BUTTES	CREEPING WESTERN SAND CHERRY
RH GR		12	RHUS AROMATICA 'GRO-LOW'	GRO-LOW FRAGRANT SUMAC
EVERGREEN SHRUBS		QTY	BOTANICAL NAME	COMMON NAME
AR CO		3	ARCTOSTAPHYLOS X COLORADOENSIS	MOCK BEARBERRY MANZANITA
AR PA		70	ARCTOSTAPHYLOS X COLORADOENSIS 'PANCHITO'	PANCHITO MANZANITA
CH MI		3	CHAMAEBATIARIA MILLEFOLIUM	FERNBUSH
HE PA		46	HESPERALOE PARVIFLORA	RED YUCCA
ORNAMENTAL GRASSES		QTY	BOTANICAL NAME	COMMON NAME
NA TE		28	NASSELLA TENUISSIMA	MEXICAN FEATHER GRASS
PERENNIALS		QTY	BOTANICAL NAME	COMMON NAME
RA PU		5	RATIBIDA COLUMNIFERA PULCHERRIMA	PRAIRIE RED CONEFLOWER

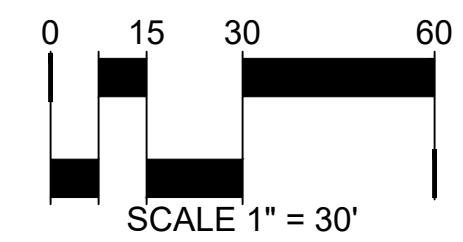
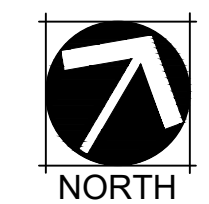

SKYLINE DRIVE
VISTA RIDGE STREETSCAPE

OWNER:
VISTA RIDGE METROPOLITAN DISTRICT

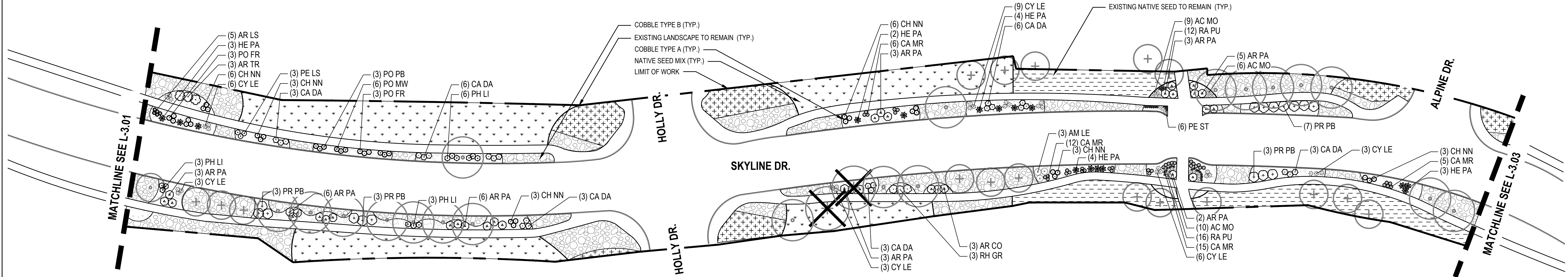

KEY MAP

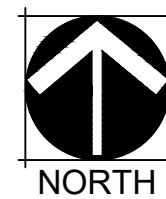
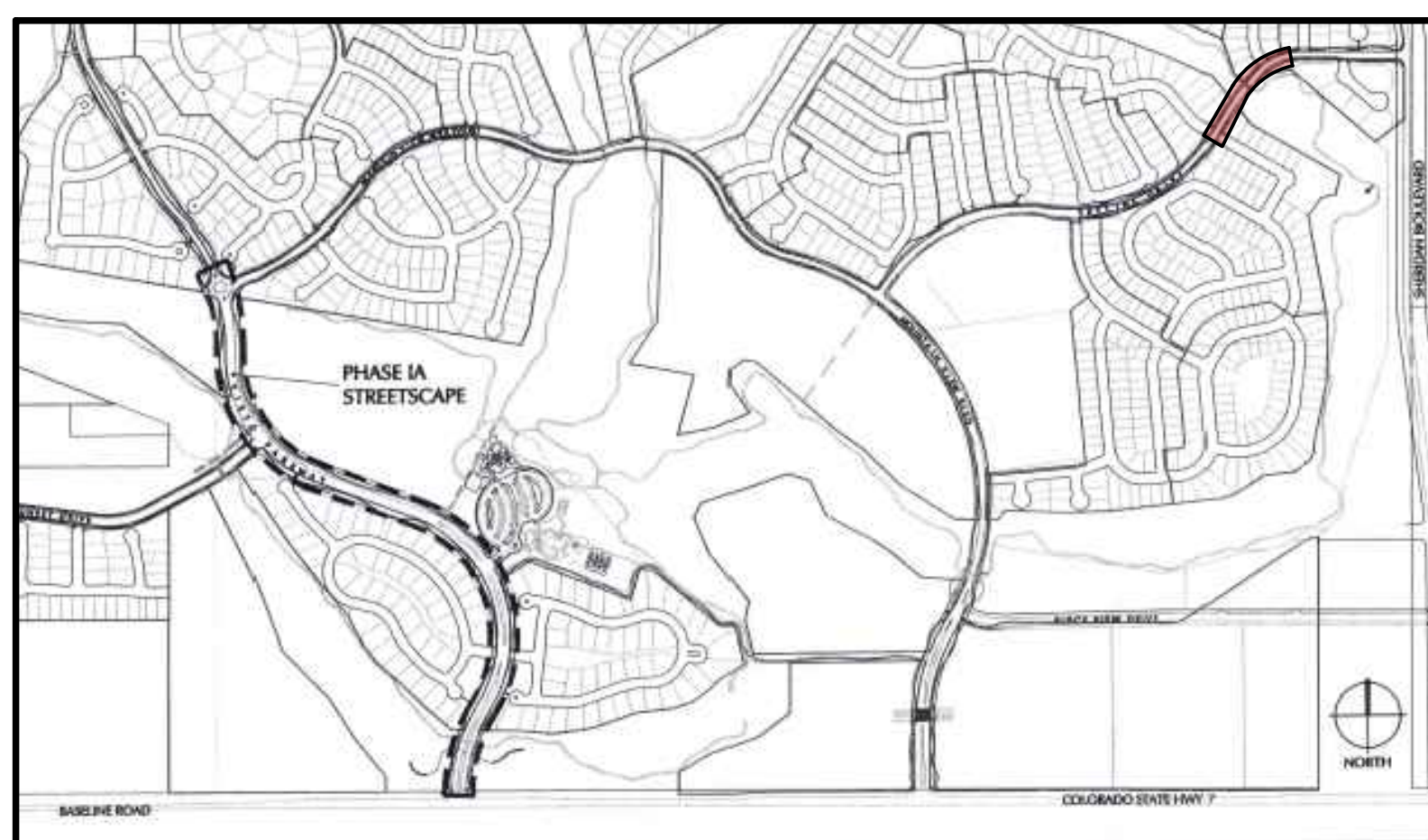

LEGEND

- NATIVE GRASS SEED MIX
- TURF
- SMALLER ROCK MULCH
- LARGER ROCK MULCH
- EXISTING LANDSCAPE TO REMAIN
- EXISTING NATIVE SEED TO REMAIN
- EXISTING LANDSCAPE TO REMAIN
- LANDSCAPE BOULDERS
- STEEL EDGER
- EXISTING TREES

PLANT SCHEDULE

DECIDUOUS SHRUBS	QTY	BOTANICAL NAME	COMMON NAME
AM LE	3	AMORPHA CANESCENS	LEADPLANT
AR LS	5	ARONIA MELANOCARPA 'UCONNAM165'	LOW SCAPE MOUND® BLACK CHOKEBERRY
AR TR	3	ARTEMISIA TRIDENTATA	BIG SAGEBRUSH
CA DA	24	CARYOPTERIS X CLANDONENSIS 'DARK KNIGHT'	DARK KNIGHT BLUEBEARD
CA MR	38	CARYOPTERIS X CLANDONENSIS CARYOPTERIS X CLANDONENSIS	BLUE MIST SPIREA
CH NN	24	CHRYSOTHAMNUS NAUSEOSUS NAUCEOSUS	BABY BLUE RABBITBRUSH
CY LE	30	CYTISUS X 'LENA'	LENA BROOM
PE LS	3	PEROVSKIA ATRIPLICIFOLIA 'LITTLE SPIRE'™	LITTLE SPIRE RUSSIAN SAGE
PH LI	12	PHYSOCARPUS OPULIFOLIUS 'LITTLE DEVIL'	LITTLE DEVIL™ DWARF NINEBARK
PO FR	6	POTENTILLA FRUTICOSA	BUSH CINQUEFOIL
PO MW	6	POTENTILLA FRUTICOSA 'MCKAY'S WHITE'	MCKAY'S WHITE BUSH CINQUEFOIL
PO PB	3	POTENTILLA FRUTICOSA 'PINK BEAUTY'	PINK BEAUTY POTENTILLA
PR PB	16	PRUNUS BESSEYI PAWNEE BUTTES	CREEPING WESTERN SAND CHERRY
RH GR	3	RHUS AROMATICA 'GRO-LOW'	GRO-LOW FRAGRANT SUMAC
EVERGREEN SHRUBS	QTY	BOTANICAL NAME	COMMON NAME
AR CO	3	ARCTOSTAPHYLOS X COLORADOENSIS	MOCK BEARBERRY MANZANITA
AR PA	31	ARCTOSTAPHYLOS X COLORADOENSIS 'PANCHITO'	PANCHITO MANZANITA
HE PA	16	HESPERALOE PARVIFLORA	RED YUCCA
PERENNIALS	QTY	BOTANICAL NAME	COMMON NAME
AC MO	25	ACHILLEA X 'MOONSHINE'	MOONSHINE YARROW
PE ST	6	PENSTEMON STRICTUS	ROCKY MOUNTAIN PENSTEMON
RA PU	28	RATIBIDA COLUMNIFERA PULCHERRIMA	PRAIRIE RED CONEFLOWER

DATE:

6/27/2023

10/13/2023

11/20/2023

12/21/2023

SHEET TITLE:

LANDSCAPE
PLAN

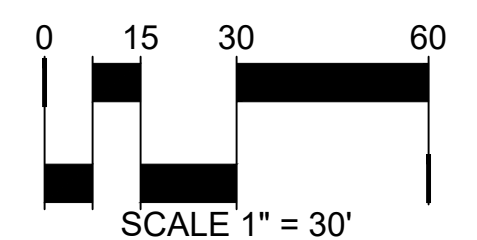

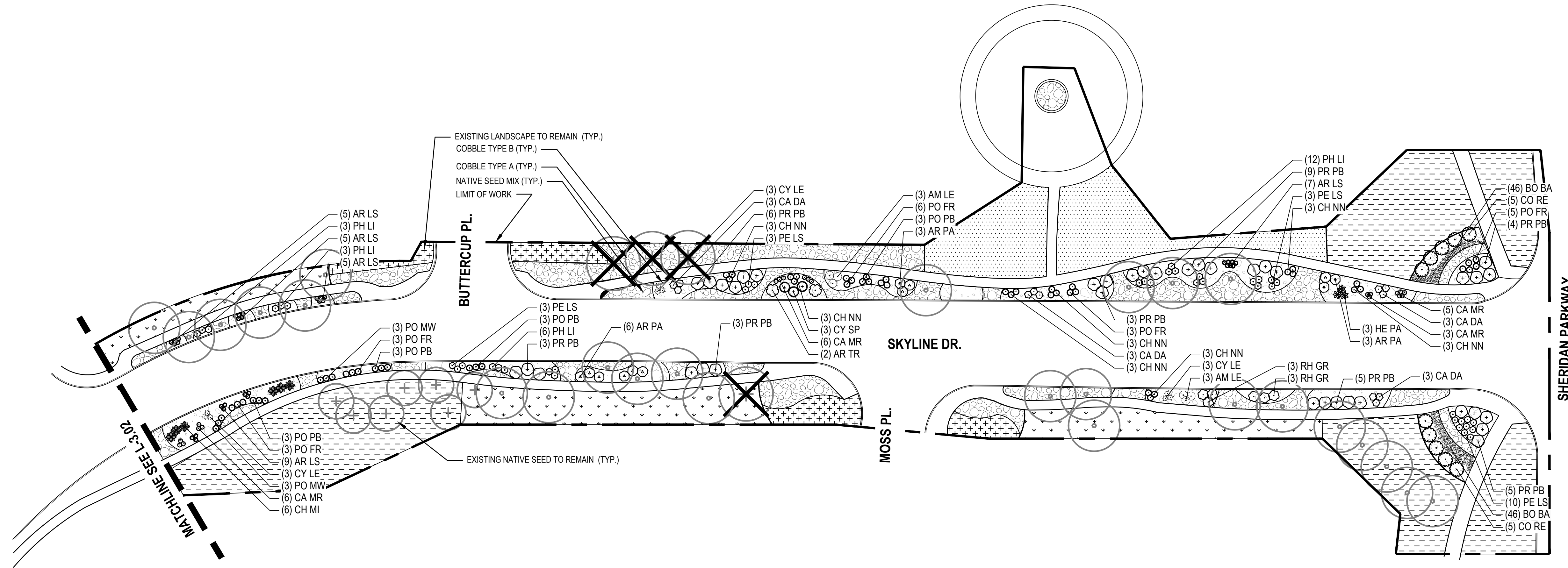

KEY MAP

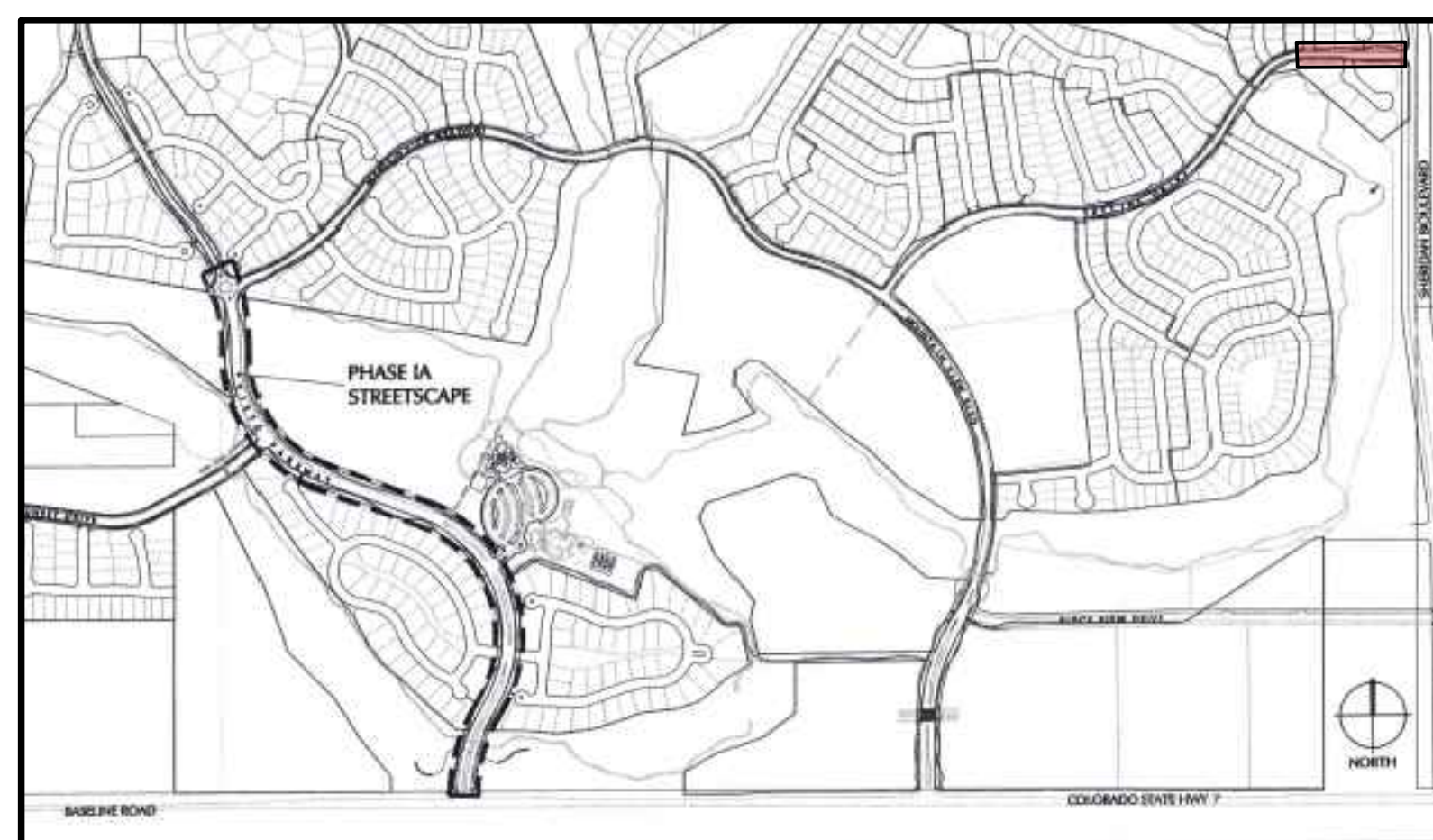

LEGEND

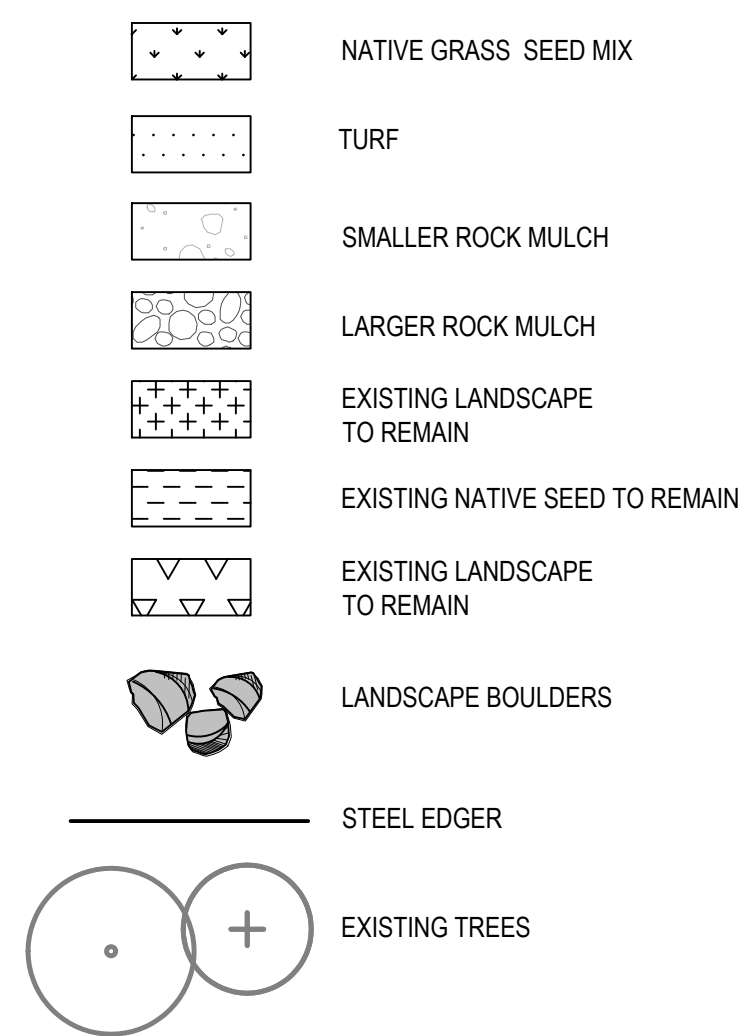

PLANT SCHEDULE

DECIDUOUS SHRUBS	QTY	BOTANICAL NAME	COMMON NAME
AM LE	6	AMORPHA CANESCENS	LEADPLANT
AR LS	31	ARONIA MELANOCARPA 'UCONNAM165'	LOW SCAPE MOUND® BLACK CHOKEBERRY
AR TR	2	ARTEMISIA TRIDENTATA	BIG SAGEBRUSH
CA DA	12	CARYOPTERIS X CLANDONENSIS 'DARK KNIGHT'	DARK KNIGHT BLUEBEARD
CA MR	20	CARYOPTERIS X CLANDONENSIS CARYOPTERIS X CLANDONENSIS	BLUE MIST SPIREA
CH NN	21	CHRYSOTHAMNUS NAUSEOSUS NAUCEOSUS	BABY BLUE RABBITBRUSH
CO RE	10	CORNUS SERICEA	RED TWIG DOGWOOD
CY SP	3	CYTISUS PURGANS 'SPANISH GOLD'	SPANISH GOLD BROOM
CY LE	9	CYTISUS X 'LENA'	LENA BROOM
PE LS	19	PEROVSKIA ATRIPLICIFOLIA 'LITTLE SPIRE'™	LITTLE SPIRE RUSSIAN SAGE
PH LI	24	PHYSOCARPUS OPULIFOLIUS 'LITTLE DEVIL'	LITTLE DEVIL™ DWARF NINEBARK
PO FR	20	POTENTILLA FRUTICOSA	BUSH CINQUEFOIL
PO MW	6	POTENTILLA FRUTICOSA 'MCKAY'S WHITE'	MCKAY'S WHITE BUSH CINQUEFOIL
PO PB	12	POTENTILLA FRUTICOSA 'PINK BEAUTY'	PINK BEAUTY POTENTILLA
PR PB	38	PRUNUS BESSEYI PAWNEE BUTTES	CREEPING WESTERN SAND CHERRY
RH GR	6	RHUS AROMATICA 'GRO-LOW'	GRO-LOW FRAGRANT SUMAC
EVERGREEN SHRUBS	QTY	BOTANICAL NAME	COMMON NAME
AR PA	12	ARCTOSTAPHYLOS X COLORADOENSIS 'PANCHITO'	PANCHITO MANZANITA
CH MI	6	CHAMAEBATIARIA MILLEFOLIUM	FERNBUSH
HE PA	3	HESPERALOE PARVIFLORA	RED YUCCA
ORNAMENTAL GRASSES	QTY	BOTANICAL NAME	COMMON NAME
BO BA	92	BOUTELOUA GRACILIS 'BLONDE AMBITION'	BLOND AMBITION BLUE GRAMA GRASS

DATE:

6/27/2023
10/13/2023
11/20/2023
12/21/2023

SHEET TITLE:

LANDSCAPE PLAN

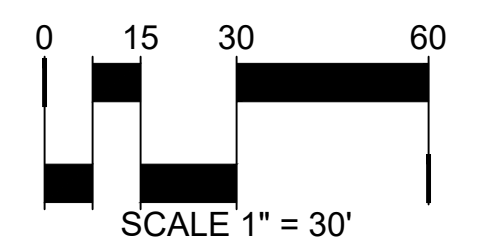

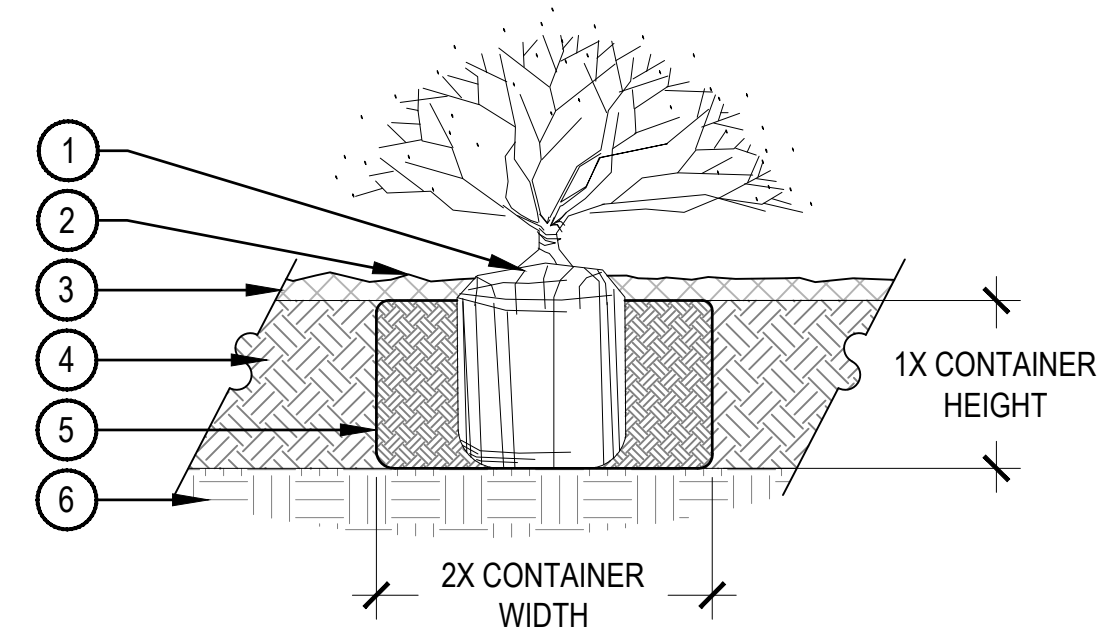

- ① SET SHRUB ROOT-BALL 1" HIGHER THAN FINISH GRADE
- ② FINISH GRADE (TOP OF MULCH)
- ③ SPECIFIED MULCH, REFER TO MATERIAL SCHEDULE, SHEET L-2.00
- ④ TILL IN SPECIFIED SOIL AMENDMENT TO A DEPTH OF 8" IN BED
- ⑤ BACKFILLED AMENDED SOIL
- ⑥ UNDISTURBED SOIL

NOTE:

1. BROKEN OR CRUMBLING ROOT-BALLS WILL BE REJECTED.
2. CARE SHOULD BE TAKEN NOT TO DAMAGE THE SHRUB OR ROOT-BALL WHEN REMOVING IT FROM ITS CONTAINER.
3. ALL JUNIPERS SHOULD BE PLANTED SO THE TOP OF THE ROOT-BALL OCCURS ABOVE THE FINISH GRADE OF THE MULCH LAYER.
4. DIG PLANT PIT TWICE AS WIDE AND AS HIGH AS THE CONTAINER.
5. PRUNE ALL DEAD OR DAMAGED WOOD PRIOR TO PLANTING, DO NOT PRUNE MORE THAN 20% OF LIMBS.

1 SHRUB PLANTING

SCALE: 1 1/2" = 1'-0"

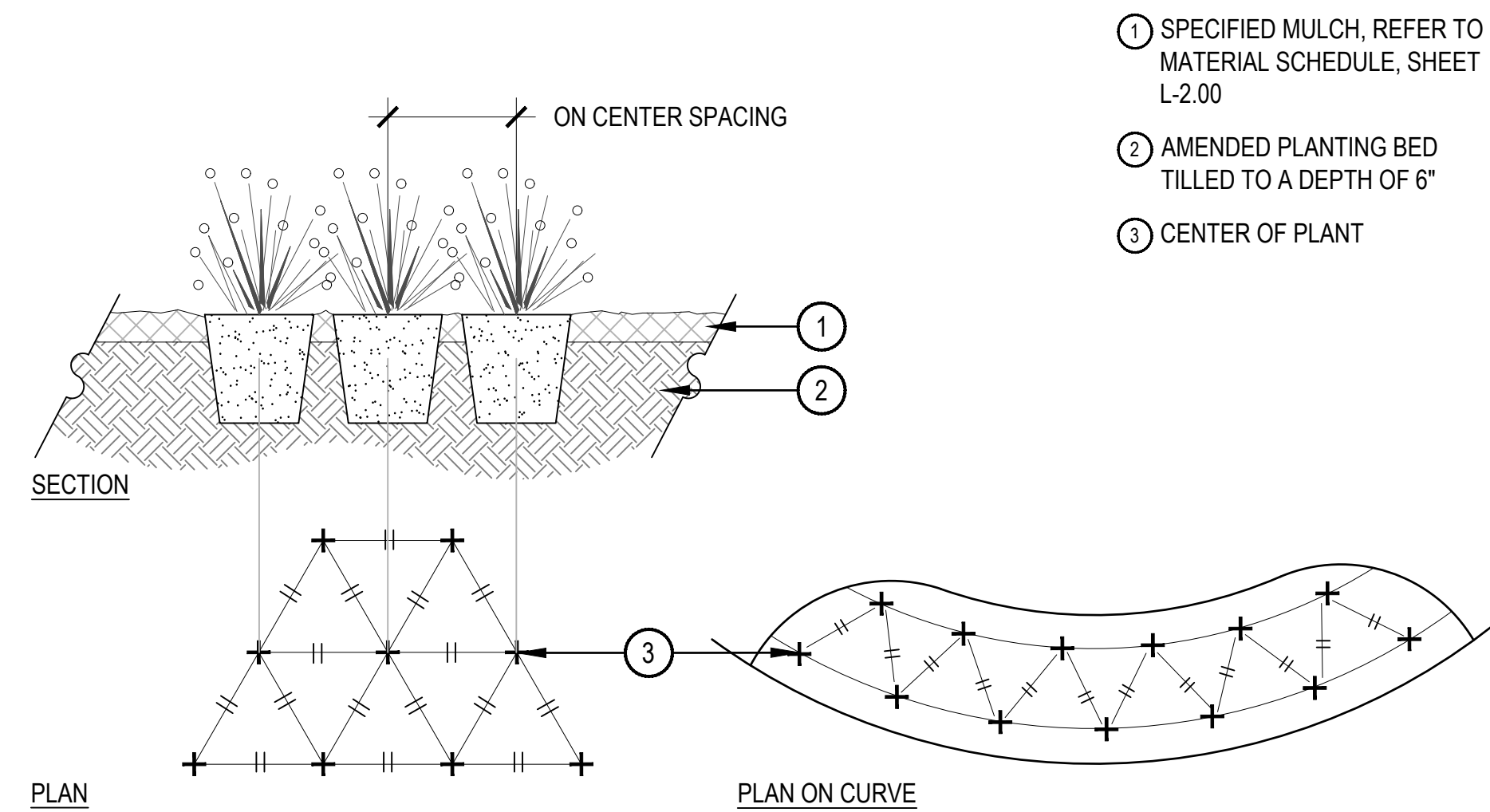

- ① SPECIFIED MULCH, REFER TO MATERIAL SCHEDULE, SHEET L-2.00
- ② AMENDED PLANTING BED TILLED TO A DEPTH OF 6"
- ③ CENTER OF PLANT

NOTES:

1. WHEN PLANTED ON A CURVE, ORIENT ROWS TO FOLLOW THE LONG AXIS OF AREAS WHERE PLANTS ARE MASSED.

3 PERENNIAL PLANT LAYOUT

SCALE: 1" = 1'-0"

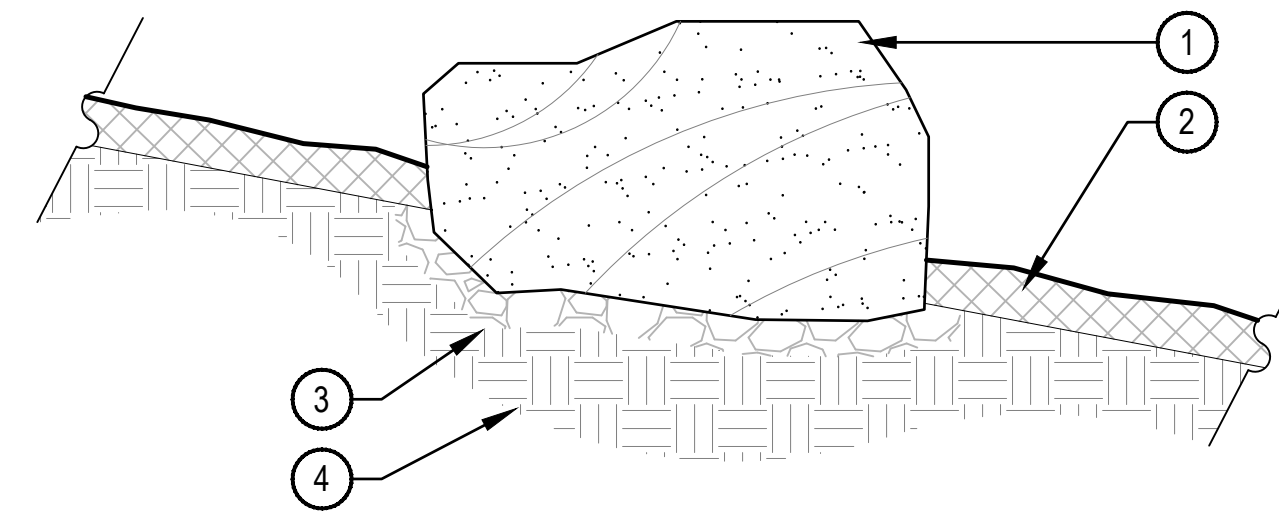

- ① BOULDER, NATURALLY SET BOULDER SO THAT A MINIMUM 1/4 OF BOULDER IS BELOW FINISH GRADE, REFER TO MATERIAL SCHEDULE, SHEET L-2.00
- ② SPECIFIED MULCH, CRUSHER FINES OR COBBLE, REFER TO PLAN
- ③ 3" MINIMUM ROAD BASE COMPACTED TO 95% OF STANDARD PROCTOR DENSITY
- ④ UNDISTURBED GRADE

NOTES:

1. THESE ARE FREE STANDING BOULDERS ONLY. BOULDERS ASSOCIATED WITH THE BOULDER RETAINING WALLS, PARK ENTRY SIGNS AND INTERPRETIVE SIGNS ARE NOT INCLUDED IN THIS COUNT.
2. THE OWNERS REPRESENTATIVE SHALL APPROVE LOCATIONS AND SIZES OF ALL BOULDERS PRIOR TO PLACING.
3. CONTRACTOR SHALL SUBMIT SAMPLE OR PHOTOS FOR APPROVAL.

2 LANDSCAPE BOULDER

SCALE: 3/4" = 1'-0"

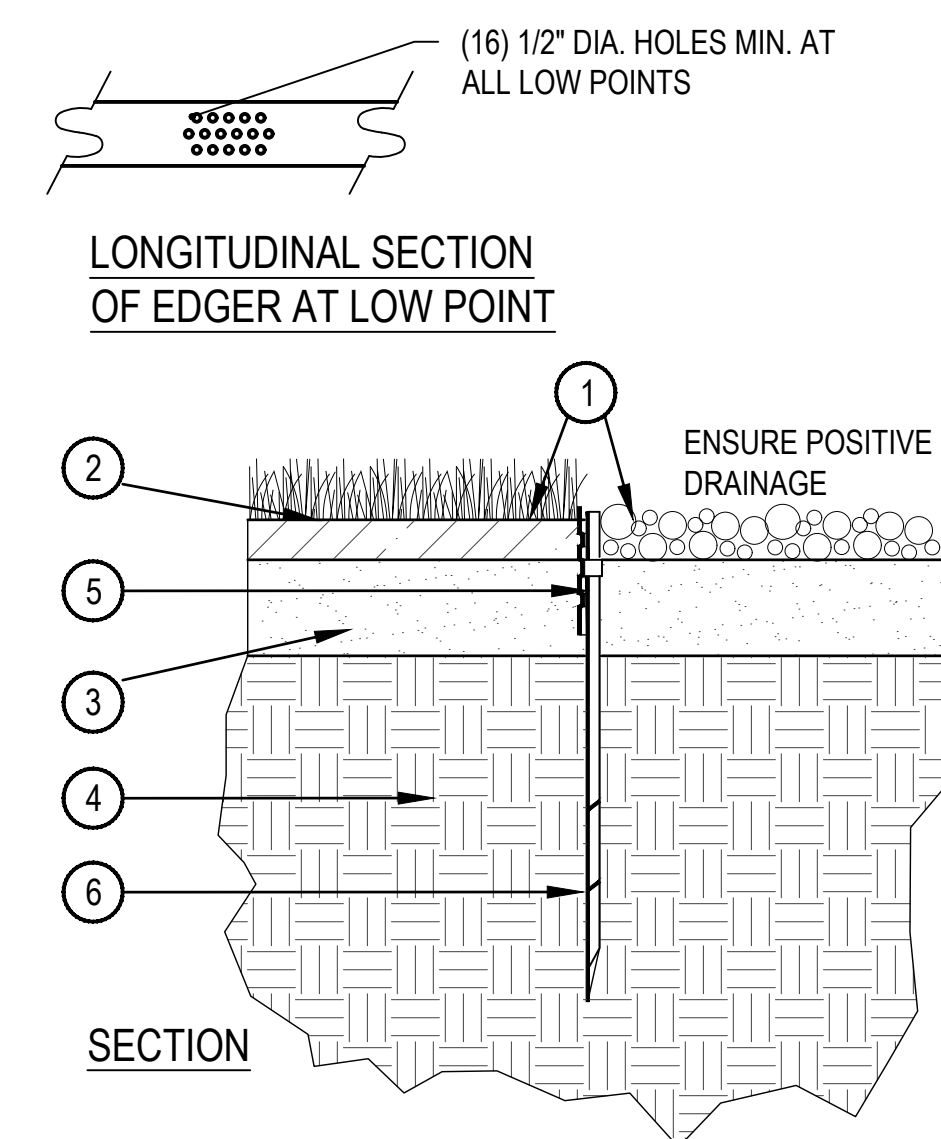

- ① FINISHED GRADE - TOP OF SOD THATCH LAYER AND TOP OF MULCH SHALL BE FLUSH WITH TOP OF EDGER
- ② TURF THATCH
- ③ AMENDED SOIL PER SPECIFICATIONS
- ④ SUBGRADE
- ⑤ STEEL EDGER - DRILL (16) 1/2" DIA. HOLES 1" O.C. MIN. AT ALL LOW POINTS OR POORLY DRAINING AREAS IN ORDER TO ENSURE ADEQUATE DRAINAGE
- ⑥ EDGER STAKE

NOTES:

1. THERE SHALL BE NO EXPOSED SHARP / JAGGED EDGES.
2. CONTRACTOR SHALL INSTALL STAKES AS REQUIRED BY THE MANUFACTURER.

4 STEEL EDGER

SCALE: 1" = 1'-0"